

# 2530H SERIES

2.5mm PITCH WIRE TO BOARD CONNECTOR

## ● Specifications

Current rating: 3A AC,DC

Voltage rating: 125VAC,DC

Temperature range: -25° C to +85° C

(including temperature rise)

Contact resistance: Initial value/10m Ω Max.

After environmental testing/20m Ω Max.

Insulation resistance: 1000000000MΩ

Withstanding voltage: 1000V AC/minute

Applicable wire: AWG#22-28

## ● Standards

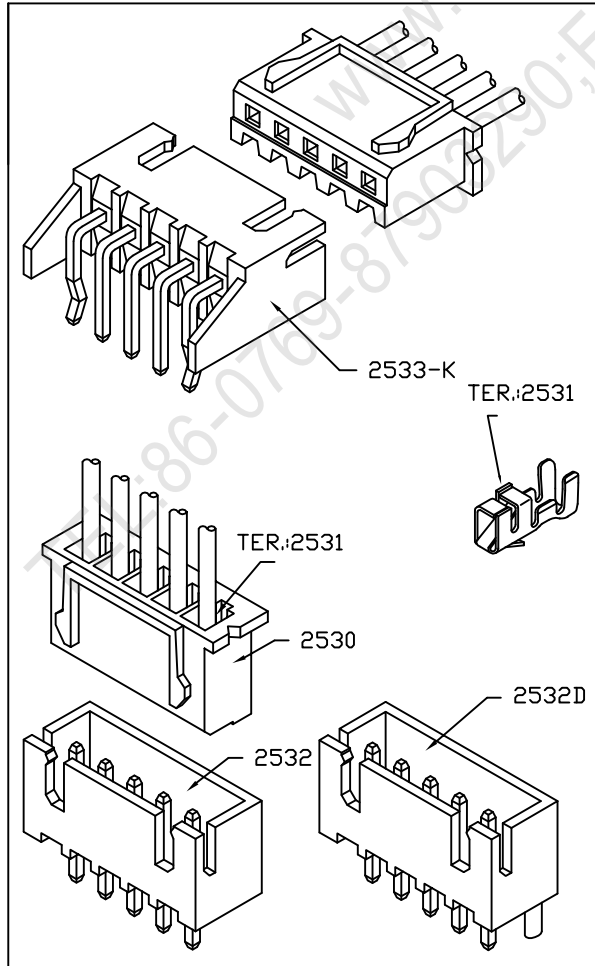

Assembly layout

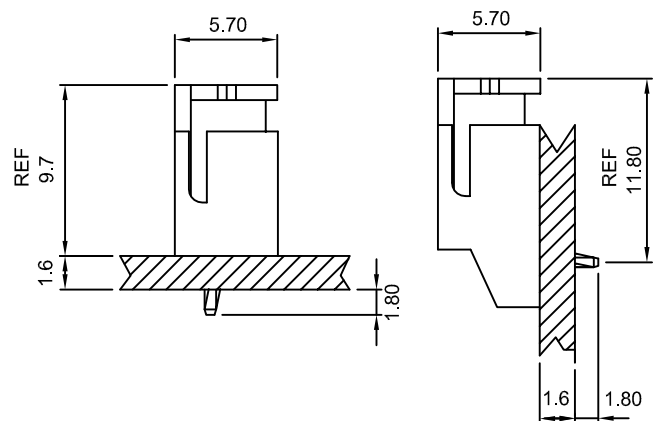

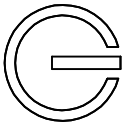

**2530** 2.50mm PITCH CRIMP HOUSING

**Features:**

MAT'L: NYLON 66 UL94 V-0  
 MATES WITH: 2531 SERIES TERMINAL  
 ACCEPTS WITH: 2532 & 2533 SERIES WAFER

unit:mm

PART NO.	A	B
2530-02	5.7	2.5
2530-03	8.2	5.0
2530-04	10.7	7.5
2530-05	13.2	10.0
2530-06	15.7	12.5
2530-07	18.2	15.0
2530-08	20.7	17.5
2530-09	23.2	20.0
2530-10	25.7	22.5
2530-11	28.2	25.0
2530-12	30.7	27.5
2530-13	33.2	30.0
2530-14	35.7	32.5
2530-15	38.2	35.0
2530-16	40.7	37.5
2530-17	43.2	40.0
2530-18	45.7	42.5
2530-19	48.2	45.0
2530-20	50.7	47.5

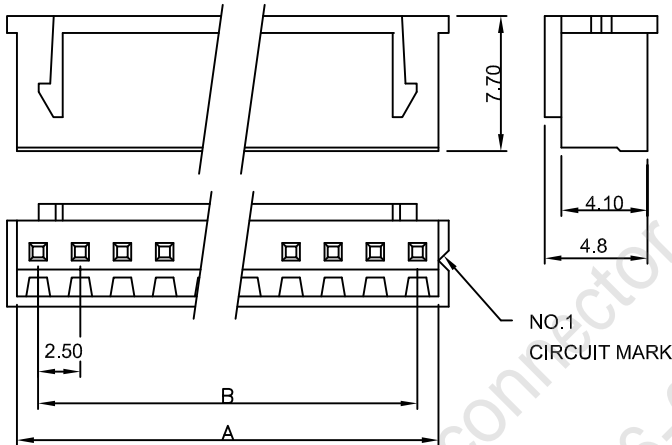

**2531** 2.50mm PITCH CRIMP TERMINAL

**Features:**

THICKNESS: 0.2mm  
 MAT'L: PHOSPHOR BRONZE OR BRASS TIN PLATED  
 MATES WITH: 2530 SERIES HOUSING  
 ACCEPT WITH: 2532 & 2533 SERIES WAFER  
 ACCEPTS : 0.64"(.025") ROUND OR SQ PIN

unit:mm

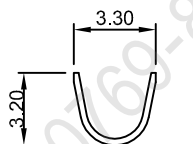

Section A-A'

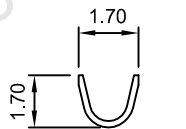

Section B-B'

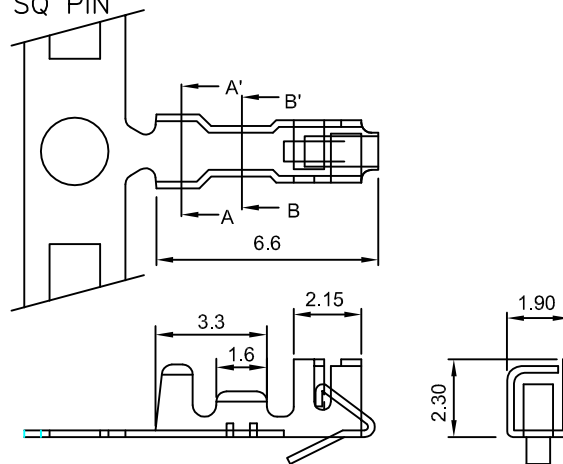

Part No	Wire Range	Insulation O.D.	Material	Finish	Qty/reel
2531	AWG#22-28	ø1.9mm max	brass	Tin-plated	8,000
2531P	AWG#22-28	ø1.9mm max	Phosphor bronze	Tin-plated	8,000



**2532**

2.5mm PITCH 180° WAFER

**Features:**

MAT'L: BODY: NYLON 66 UL94V-0  
 PINS: BRASS TIN PLATED  
 MATES WITH: 2531 SERIES TERMINAL  
 ACCEPTS WITH: 2530 SERIES HOUSING

unit:mm

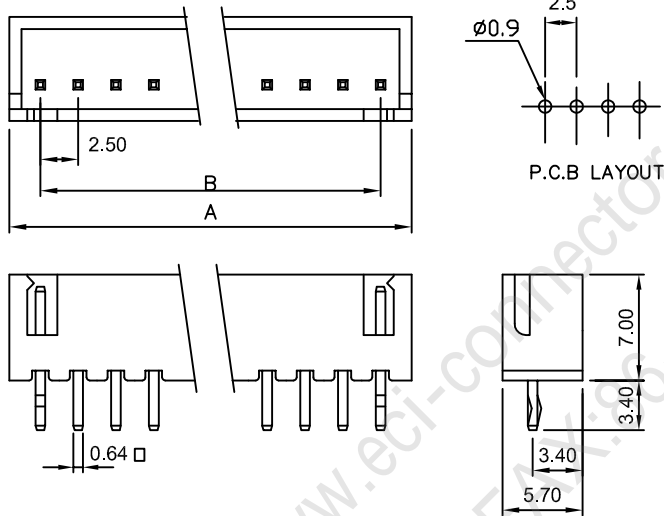

PART NO.	A	B
2532-02	7.5	2.5
2532-03	10.0	5.0
2532-04	12.5	7.5
2532-05	15.0	10.0
2532-06	17.5	12.5
2532-07	20.0	15.0
2532-08	22.5	17.5
2532-09	25.0	20.0
2532-10	27.5	22.5
2532-11	30.0	25.0
2532-12	32.5	27.5
2532-13	35.0	30.0
2532-14	37.5	32.5
2532-15	40.0	35.0
2532-16	42.5	37.5
2532-17	45.0	40.0
2532-18	47.5	42.5
2532-19	50.0	45.0
2532-20	52.5	47.5

**2533-K**

2.5mm PITCH 90° WAFER

**Features:**

MAT'L: BODY: NYLON 66 UL94V-0  
 PINS: BRASS TIN PLATED  
 MATES WITH: 2531 SERIES TERMINAL  
 ACCEPTS WITH: 2530 SERIES HOUSING

unit: mm

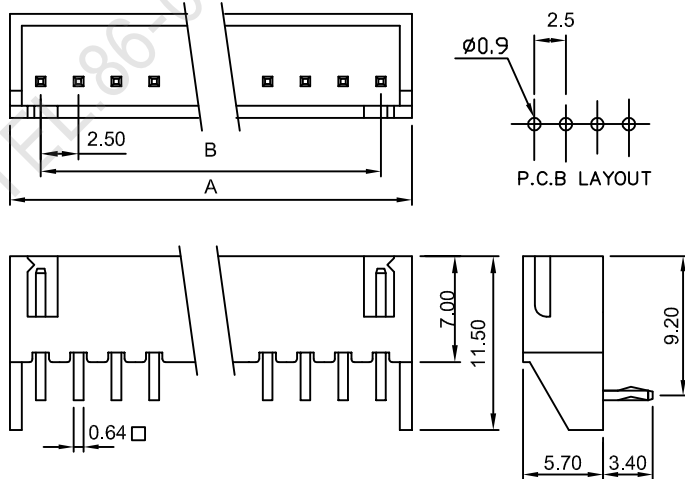

PART NO.	A	B
2533-02K	7.5	2.5
2533-03K	10.0	5.0
2533-04K	12.5	7.5
2533-05K	15.0	10.0
2533-06K	17.5	12.5
2533-07K	20.0	15.0
2533-08K	22.5	17.5
2533-09K	25.0	20.0
2533-10K	27.5	22.5
2533-11K	30.0	25.0
2533-12K	32.5	27.5
2533-13K	35.0	30.0
2533-14K	37.5	32.5
2533-15K	40.0	35.0
2533-16K	42.5	37.5
2533-17K	45.0	40.0
2533-18K	47.5	42.5
2533-19K	50.0	45.0
2533-20K	52.5	47.5



# 2530CH SERIES

2.5mm PITCH WIRE TO WIRE CONNECTOR

## ● Specifications

Current rating: 3A AC,DC

Voltage rating: 125V AC,DC

Temperature range: -25° C to+85° C

(including temperature rise)

Contact resistance: Initial value/10m  $\Omega$  Max.

After environmental testing/20m  $\Omega$  Max.

Insulation resistance: 1000M  $\Omega$  MIN.

Withstanding voltage: 1000V AC/minute

Applicable wire: AWG#22-28

## ● Standards

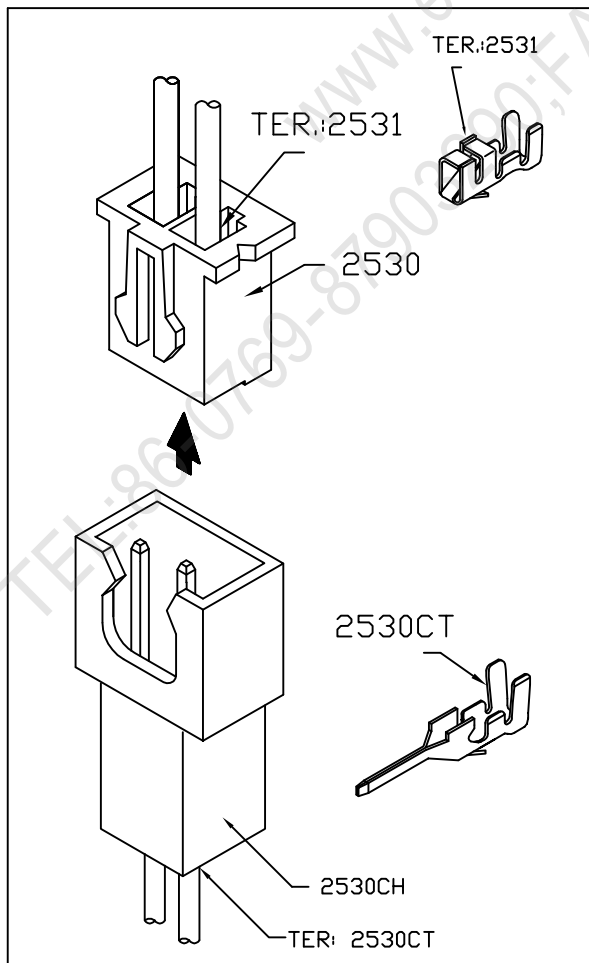

Assembly layout

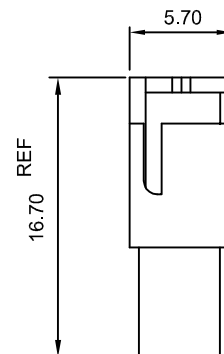

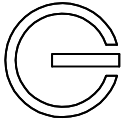

**2532D**

2.5mm PITCH 180° WAFER

**Features:**

MAT'L: BODY: NYLON 66 UL94V-0  
 PINS: BRASS TIN PLATED  
 MATES WITH: 2531 SERIES TERMINAL  
 ACCEPTS WITH: 2530 SERIES HOUSING  
 BOSS TYPE IS INSERTED  
 AT THE RIGHT SIDE OF P.C.B

unit:mm

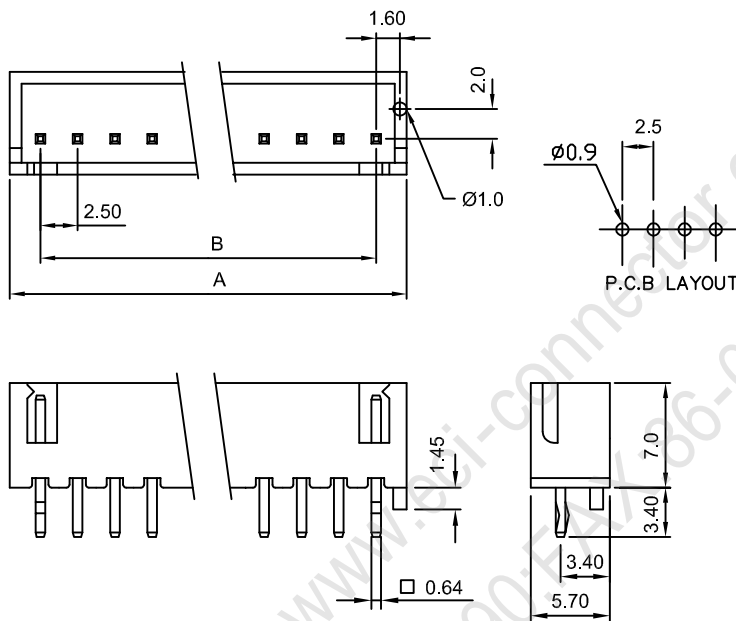

PART NO.	A	B
2532D- 02	7.5	2.5
2532D- 03	10.0	5.0
2532D- 04	12.5	7.5
2532D- 05	15.0	10.0
2532D- 06	17.5	12.5
2532D- 07	20.0	15.0
2532D- 08	22.5	17.5
2532D- 09	25.0	20.0
2532D- 10	27.5	22.5
2532D- 11	30.0	25.0
2532D- 12	32.5	27.5
2532D- 13	35.0	30.0
2532D- 14	37.5	32.5
2532D- 15	40.0	35.0
2532D- 16	42.5	37.5
2532D- 17	45.0	40.0
2532D- 18	47.5	42.5
2532D- 19	50.0	45.0
2532D- 20	52.5	47.5

**2530CH**

2.5mm PITCH HOUSING

**Features:**

MAT'L: NYLON 66 UL94V-0  
 MATES WITH: 2530CT SERIES TERMINAL  
 ACCEPTS WITH: 2530H SERIES HOUSING

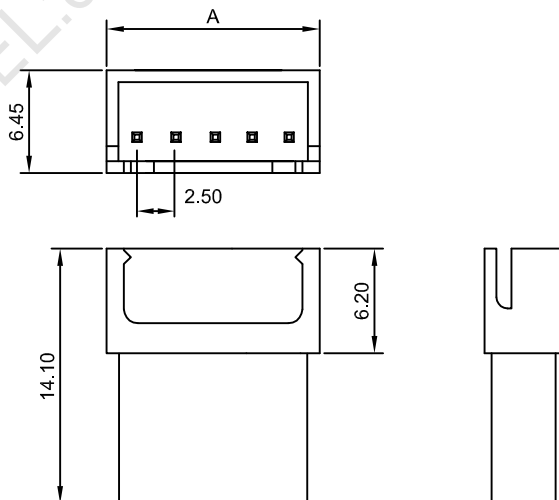

PART NO.	A	B
2530CH- 02	7.5	2.5
2530CH- 03	10.0	5.0
2530CH- 04	12.5	7.5
2530CH- 05	15.0	10.0
2530CH- 06	17.5	12.5
2530CH- 07	20.0	15.0
2530CH- 08	22.5	17.5
2530CH- 09	25.0	20.0
2530CH- 10	27.5	22.5
2530CH- 11	30.0	25.0
2530CH- 12	32.5	27.5
2530CH- 13	35.0	30.0
2530CH- 14	37.5	32.5
2530CH- 15	40.0	35.0
2530CH- 16	42.5	37.5
2530CH- 17	45.0	40.0
2530CH- 18	47.5	42.5
2530CH- 19	50.0	45.0
2530CH- 20	52.5	47.5



## 2530CT 2.50mm PITCH TERMINAL

### Features:

THICKNESS: 0.2mm

MAT'L: BRASS TIN PLATED

MATES WITH: 2530CH SERIES HOUSING

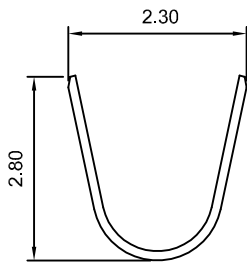

Section A-A'

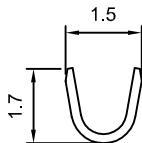

Section B-B'

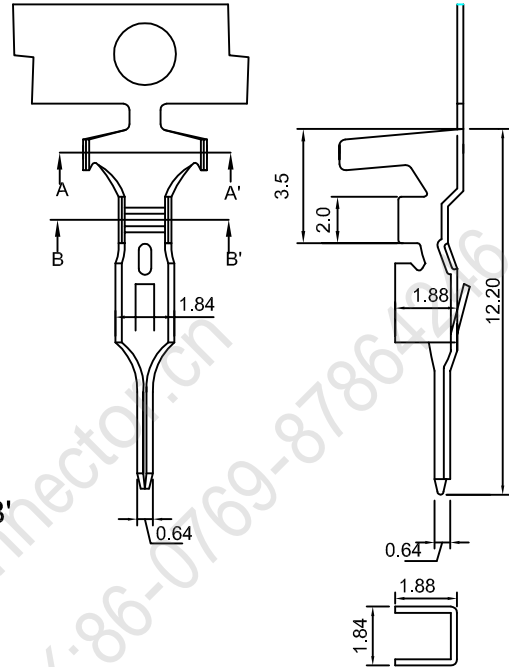

Part/NO.	Wire Range	Material	Finish	Qty/reel
2530CT	AWG#28-24	BRASS	Tin-Plated	5,000